

PERFORMANCE SPECIFICATION TABLE

Notes :

1. Injection capacity and plasticizing capacity values are dependent on molding conditions and materials used.
2. Weight per shot is 90% of theoretical value. (GPPS)
3. The foregoing specifications are subject to change without notice.
4. ★ : Standard models.

MACHINE TYPE		FN7000						FN8000				
SPECIFICATION ITEM	UNIT	100A ★			140A			160A ★			210L	
		(A)	(B)	(C)	(A)	(B)	(C)	(A)	(B)	(C)	(A)	(B)
Screw diameter	inch	2.5	2.8	3.1	2.8	3.1	3.5	2.8	3.1	3.5	3.1	3.5
	mm	63	71	80	71	80	90	71	80	90	80	90
Injection capacity (PS)	in ³	48.5	61.6	78.1	67.7	86.0	108.6	77.5	98.2	123.9	128.7	162.9
	cm ³	795	1010	1280	1110	1410	1780	1270	1610	2030	2110	2670
	oz	25.2	32.1	40.6	35.2	44.8	56.5	40.3	51.1	64.4	67.0	84.8
Calculated plasticizing capacity (PS)	lbs/h	357	503	699	447	626	851	441	604	838	668	904
	kg/h	162	228	317	203	284	386	200	274	380	303	410
Injection pressure	psi	29790	23470	18490	28440	22400	17690	28440	22400	17710	27020	21330
	kgf/cm ²	2095	1650	1300	2000	1575	1244	2000	1575	1245	1900	1500
Injection rate	in ³ /s	16.1	20.5	26.0	19.3	24.5	31.0	24.0	30.5	38.6	35.4	44.8
	cm ³ /s	264	336	426	316	402	509	394	500	633	581	735
Screw speeds	Constant torque	0 ~ 120			0 ~ 120			0 ~ 120			0 ~ 150	
	Variable torque	120 ~ 190			120 ~ 170			120 ~ 180			150 ~ 170	
Hopper capacity	Gal	23.8						23.8				
	L	90						90				
Mold clamping force	US ton	396						501				
	tonf	361						455				
Mold clamping stroke	inch	38.2						40.3				
	mm	970						1025				
Minimum mold thickness	inch	13.8						14.8				
	mm	350						375				
Maximum daylight opening	inch	52.0						55.1				
	mm	1320						1400				
Clearance between tie bars (H×V)	inch	28.9×28.9						32.3×32.3				
	mm	735×735						820×820				
Die plate dimensions (H×V)	inch	41.5×41.5						46.8×46.8				
	mm	1055×1055						1190×1190				
Ejector stroke	inch	5.9						6.3				
	mm	150						160				
Pump motor	kW	37 [50HP]			45 [60HP]			55 [75HP]			75 [100HP]	
Heater band capacity	kW	24.25			31.88			33.68				
Amount of hydraulic oil required	Gal	259						359				
	L	980						1360				
Machine dimensions (L×W×H)	inch	294.9×67.7×92.1			311.4×67.7×92.1			324.4×78.7×101.6			339.4×78.7×101.6	
	m	7.49×1.72×2.34			7.91×1.72×2.34			8.24×2.00×2.58			8.62×2.00×2.58	
Floor dimensions (L×W)	inch	261.0×53.5			273.6×53.5			289.0×58.7			296.8×58.7	
	m	6.63×1.36			6.95×1.36			7.34×1.49			7.54×1.49	
Machine weight	lbs	32628			33951			45636			47179	
	ton	14.8			15.4			20.7			21.4	

FN8000 Injection unit 160A

EXTERNAL VIEW

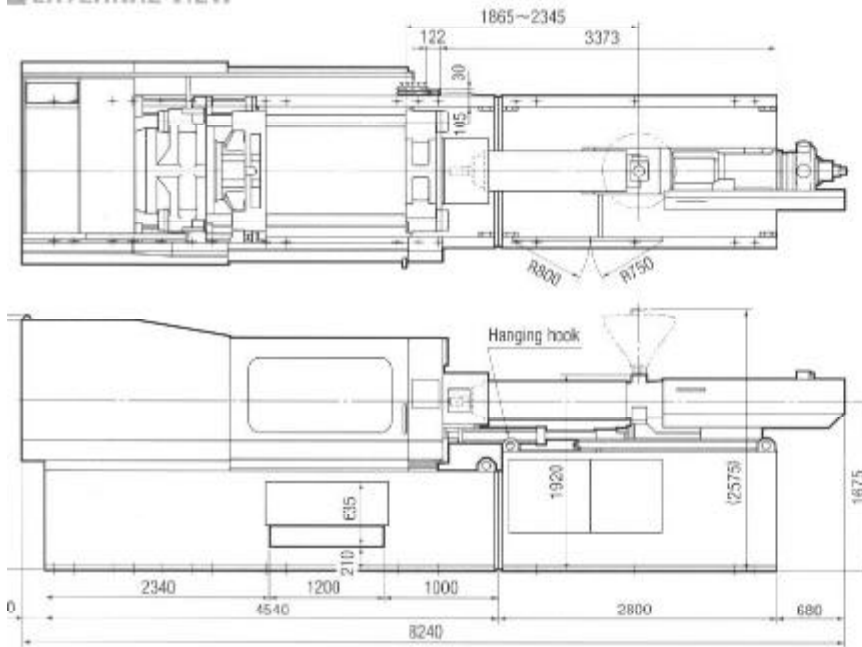

※	
3-phase AC power	
230/460V 60Hz	
Pump motor	kW 55.0
Heater	kW 33.68
Control	kW 1.0
Total	kW 89.68
	kVA 109.68

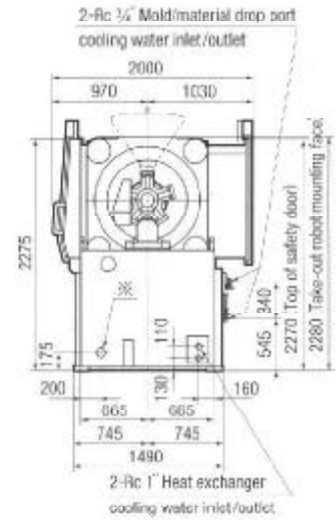

FOUNDATION DIAGRAM

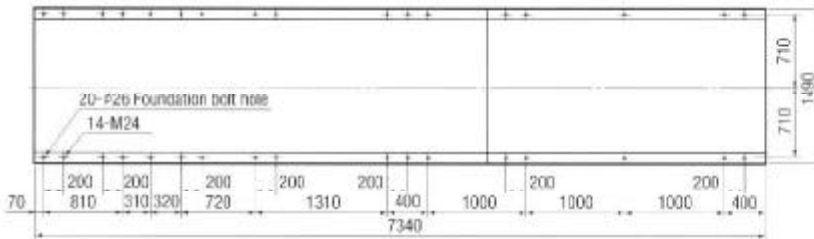

TAKE OUT ROBOT FIXATION DIAGRAM

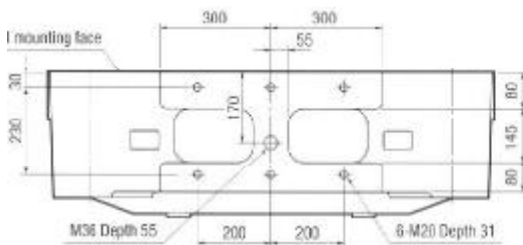

HOPPER FIXATION DIAGRAM

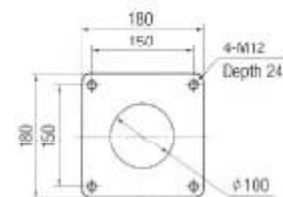

MOLD ATTACHMENT DIAGRAM

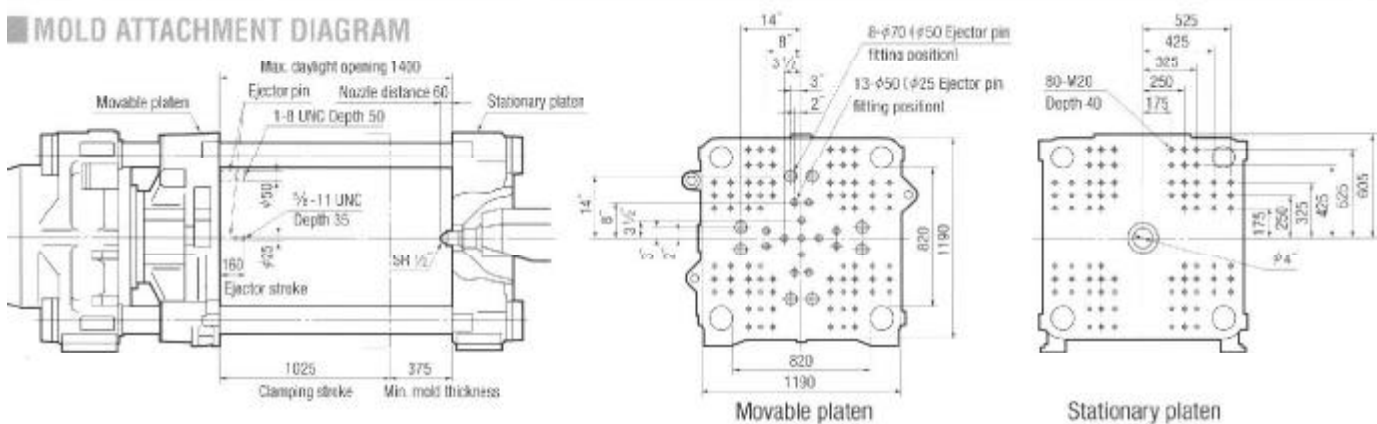

EXTERNAL VIEW

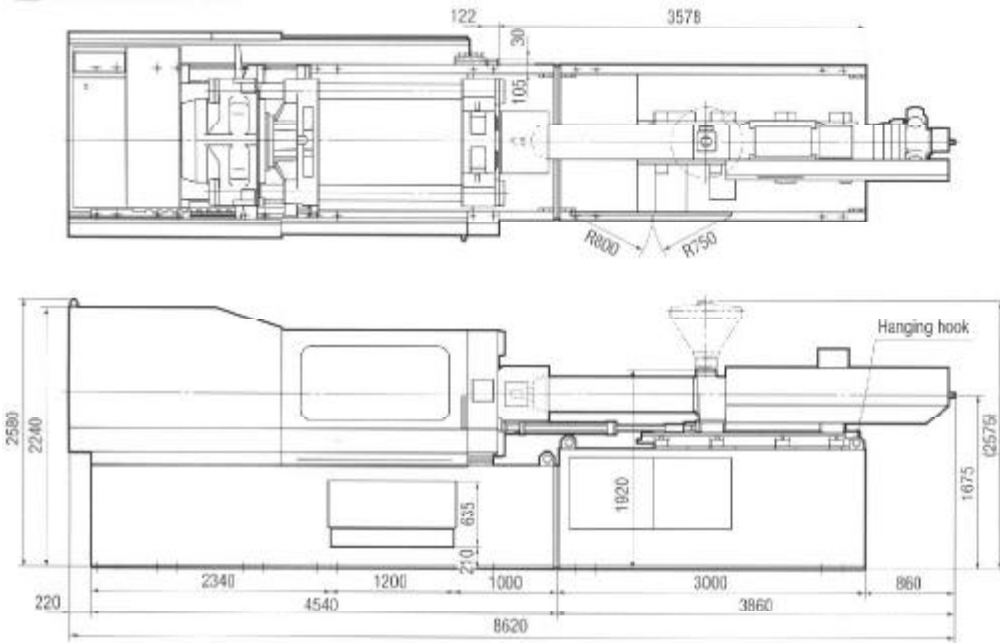

3-phase AC power		
230/460V 60Hz		
Pump motor	KW	75.0
Heater	KW	33.68
Control	KW	1.0
Total	KVA	134.68

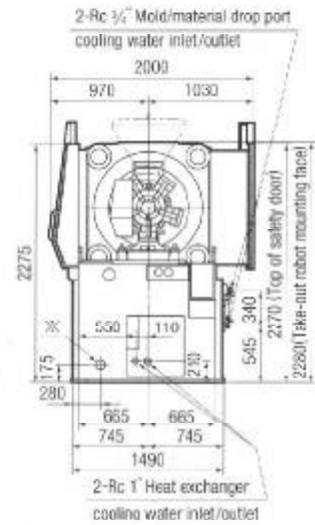

FOUNDATION DIAGRAM

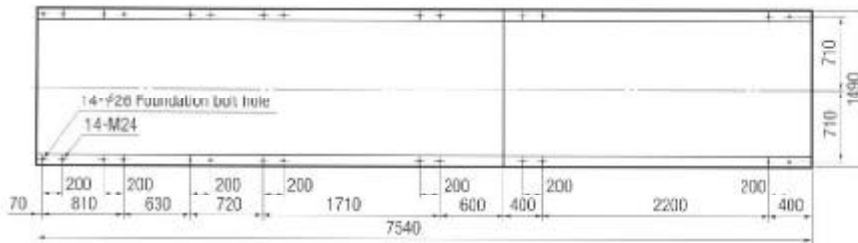

TAKE OUT ROBOT FIXATION DIAGRAM

HOPPER FIXATION DIAGRAM

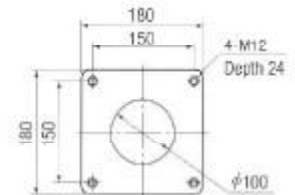
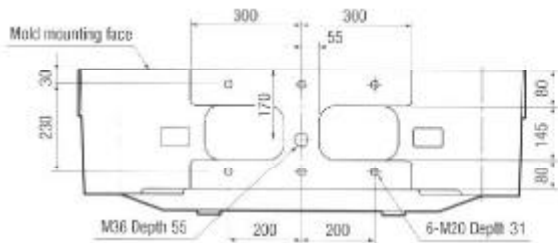

MOLD ATTACHMENT DIAGRAM

